

Legend



-Adjustable part (cut to fit)



-Adhesive thinset or epoxy

OPTION 1

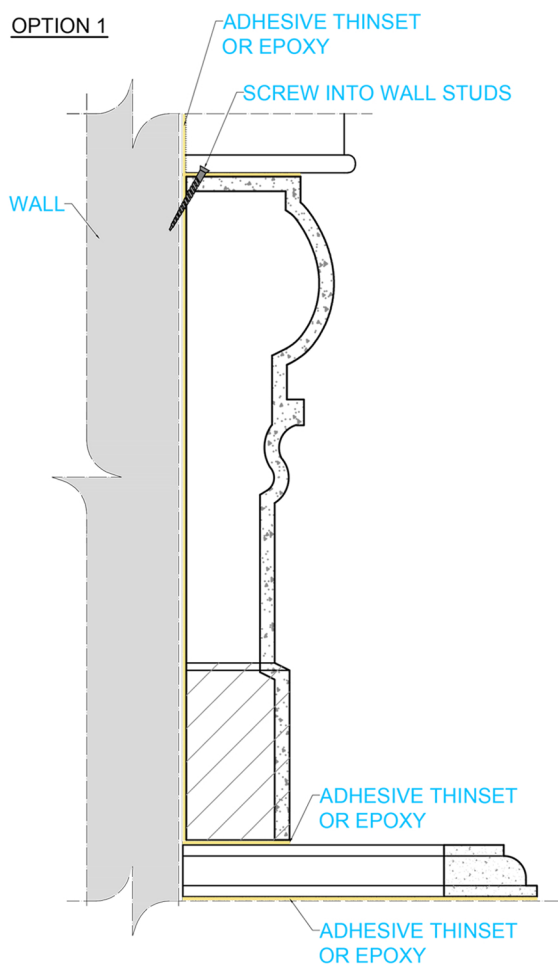

OPTION 2

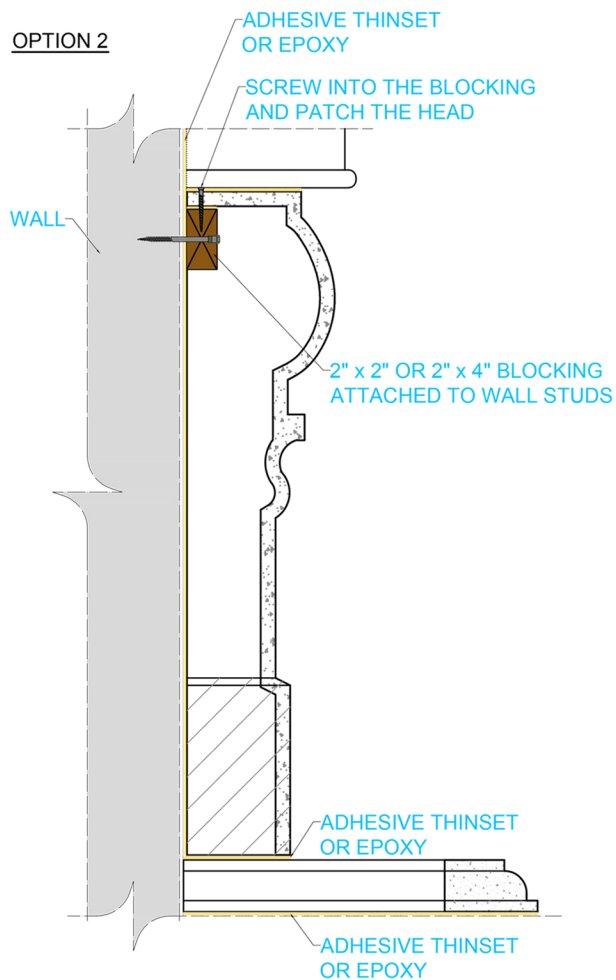

EXAMINATION

A. Do not begin installation until all substrates have been properly constructed and inspected:

Verify that all are plumb and true.

B. Notify Architect of unsatisfactory substrate preparation if done by another party.

C. If unsatisfactory conditions exist, proceed with installation only once they have been rectified.

D. Check as-built dimensions against as-drawn and verify that field dimensions will allow for proper installation.

If dimensions don't allow for proper installation, notify the Architect . Wait for instructions prior to commencing installation.

PREPARATION

A. Clean surfaces thoroughly and properly prior to installation.

B. Prepare surfaces in the manner recommended by LA PRECAST MANTELS for achieving the best results for the substrate under the project conditions.

INSTALLATION

A. Install in compliance with applicable code and in accordance to LA PRECAST MANTELS recommendations:

Install plumb and true to line and shim where necessary.

B. Provide expansion joints in areas where moving joints in substrate occur.

C. Patch exposed anchor points, if any, to match color and texture of unit.

D. Clean GFRC product according to LA PRECAST MANTELS cleaning instructions.

1. Remove dirt, stains, or any other residue.

2. Protect surrounding materials and surfaces during cleaning.

PROTECTION

A. Protect installed fireplace surround until the completion of the project.

B. If damaged, touch-up, repair, or replace before substantial completion.